

BRISTOL CITY COUNCIL

PUBLIC RIGHTS OF WAYS AND GREENS COMMITTEE

5 DECEMBER 2011

Report of: Commons Registration Authority

Title: Current applications for registration of land as town or village greens

Ward: Citywide

Officer Presenting Report: Anne Nugent, Senior Solicitor, Legal Services

Contact Telephone Number: 0117 9223424

RECOMMENDATION

To note the present position with regards Town or Village Green applications

Summary

This report contains a schedule of the present position with regards Town or Village Green applications duly made under the Commons Act 2006

The significant issues in the report are:

The present position with regards Town or Village Green applications

Policy

1. There are no specific policy implications arising from this report.

Consultation

2. Internal

Not applicable

3. External

Not applicable

Context

4. To update the Schedule of Town & Village Green Applications to show the current position

Proposal

5. None

Other Options Considered

6. None

Risk Assessment

7. None undertaken as no decision is being taken at this stage

Legal and Resources Implications

Legal

Each Application will have a separate report to Committee at the appropriate time.

Legal advice provided by: Anne Nugent, Senior Solicitor, Legal Services.

Financial

(a) Revenue

Any legal costs on the Council arising from these applications would need to be contained within the approved budget.

(Financial advice provided by Principal Accountant, Dave Miles)

(b) Capital

There are no specific policy implications arising from this report.

Land

There are no specific policy implications arising from this report.

Personnel

Not applicable

Appendices

Appendix A – Schedule of the present position with regards Town or Village Green applications duly made under the Commons Act 2006

Appendix A (i) - Map of Filwood Open Space – Application No: 14

Appendix A (ii) - Map of Grove Wood – Application No: 15

Appendix A (iii) - Map of Okebourne Open Space – Application No: 16

Appendix A (iv) - Map of Wellington Hill Playing Fields – Application No: 18

Appendix A (v) - Map of Bracey Drive, Frenchay – Application No: 19

Appendix A (vi) - Map of Higham Street Green - Application No: 20

Appendix A (vii) - Map of Elderberry Walk Open Space – Application No: 21

Appendix A (viii) - Map of Arnall Drive Open Space – Application No: 22

Appendix A (ix) - Map of Stoke Lodge Playing Field – Application No: 24

Appendix A (x) - Map of Laundry Field – Application No: 25.

Local Government (Access to Information) Act 1985

Background Papers:

Application papers available at the Council House, College Green.

Section 15 Commons Act 2006

Commons (Registration of Town or Village Greens) (Interim Arrangements) (England) Regulations 2007

APPENDIX (7) A

Schedule of current Town or Village Green Applications that have been duly made.

Updated 24 November 2011.

Filwood Park Open Space (File No. JD5/428)

- **Application No:** 14
- **Date Application received:** 12 November 2009
- **Description of Application land:** Filwood Park Open Space
- **Location of Application land:** Land bounded by Hengrove Way, Creswicke Road and Filwood Playing Fields (Application Map Appendix No. A (i))
- **Applicant:** Mil Lusk
- **Landowner:** Urban Regeneration Agency
- **State of Application:** Inspector's report received and circulated to parties. Officers report with recommendations to be submitted to next PRoGW meeting.

Grove Wood (File No. JD5/379)

- **Application No:** 15
- **Date Application received:** 26 November 2009
- **Description of Application land:** Grove Wood
- **Location of Application land:** Woodland below Blackberry Hill Hospital next to River Frome, Stapleton Bristol (Application Map Appendix No. A (ii))
- **Applicant:** Snuff Mills Action Group C/O Mr Steve Micklewright,
- **Land owner:** The Rhino Group Ltd
- **State of Application:** Inspectors report expected by end of November 2011.

Okebourne Open Space, Brentry (File No. JD5/435)

- **Application No:** 16
- **Date Application received:** 16 July 2010
- **Description of Application land:** Okebourne Park or Oakwood Park
- **Location of Application land:** Leading of Knole Lane and Chakes Hill Drive, Brentry BS10 (Application Map Appendix No. A (iii))
- **Applicant:** Mr John Rich on behalf of the Friends of Okebourne Open Space
- **State of Application:** Statement of Objections received from landowner.
- **Landowner:** Bristol City Council
- Response to Objections received from Applicants. CRA officers to submit their report to Strategic Director who will then instruct officers on the next steps.

Wellington Hill Playing Fields (File No: JD5/438)

- **Application No:** 18
- **Date Application received:** 12 October 2010
- **Description of Application land:** Wellington Hill Playing Field
- **Location of Application land:** Wellington Hill, Horfield, Bristol (Application Map Appendix No. A (iv))
- **Applicant:** Mr Gavin Boby
- **Landowner:** Bristol City Council

State of Application: Statement of Objections received from landowner. Response to Objections received from Applicants. CRA officers to submit their report to Strategic Director who will then instruct officers on the next steps

Bracey Drive, Frenchay (File No. JD5/434)

- **Application No:** 19
- **Date Application received:** 13 October 2010
- **Description of application land:** Green
- **Location of Application land:** Bordered by Frenchay Road, Long Close and Bracey Drive, Bristol BS16 (Application Map Appendix No. A (v))
- **Applicant:** Mr Anthony Thomas
- **Landowner:** Bristol City Council
- **State of application:** Statement of Objections received from landowner. Applicant is now represented by Solicitors who have written to CRA on 22 November 2011 demanding that the CRA register the land without delay. CRA officers to submit their report to Strategic Director who will then instruct officers on the next steps

Higham Street Green, (File No. JD5/441)

- **Application No:** 20
- **Date Application received:** 22 October 2010
- **Description of Application land:** Higham Street Green/Higham Street Open Space
- **Location of Application land:** Higham Street, Totterdown, Bristol (Application Map Appendix No. A (vi))
- **Applicant:** Ms Joanne Fisher
- **Landowner:** Bristol City Council
- **State of Application:** Statement of Objections received from landowner. Applicant's response awaited.

Elderberry Walk Open Space (File No. JD5/446)

- **Application No:** 21
- **Date Application received:** 10 January 2011
- **Description of Application land:** Elderberry Walk Open Space
- **Location of Application land:** land on the south east side of Charlton Road, Southmead Bristol (Application Map Appendix No. A (vii))
- **Applicant:** Mrs Alison E. Devonshire
- **Landowner:** Bristol City Council
- **State of Application:** Statement of Objections received from landowner. Response to Objections received from Applicants on 10 November 2011. CRA officers to submit their report to Strategic Director who will then instruct officers on the next steps.

Arnall Drive Open Space (File No. JD5/448)

- **Application No:** 22
- **Date Application received:** 31 January 2011
- **Description of Application land:** Arnall Drive Open Space
- **Location of Application land:** Arnall Drive Henbury Bristol (Application Map Appendix No. A (viii))
- **Applicant:** Ms Marilyn June Tiley
- **Landowner:** Bristol City Council

- **State of Application:** Statement of Objections due 20 January 2012.

Stoke Lodge Playing Fields (file number JD5/450)

- **Application No:** 24
- **Date Application received:** 7 March 2011
- **Description of Application land:** Stoke Lodge Playing Fields,
- **Location of Application land:** Stoke Lodge Playing Fields, Shirehampton Road, Stoke Bishop, Bristol BS9 1BN. (Application Map Appendix No. A (ix))
- **Applicant:** Save Stoke Lodge Parkland
- **Landowner:** Bristol City Council
- **State of Application:** Statements of Objections received and sent to Applicant for response in accordance with Regulation 6.3.of the Commons (Registration of Town or Village Greens) (Interim Arrangements) (England) Regulations 2007.

Laundry Field (File Number JD5.460)

- **Application No.** 25
- **Date Application received:** 1 June 2011
- **Description of Application land:** Laundry Field
- **Location:** Fishponds (Application No. A (x))
- **Applicant:** Snuff Mills Action Group
- **Land owner:** Homes and Communities Agency
- **State of Application:** Statement of objections to be received by 14 January 2012.

Land Registry
Official copy of
title plan

Title number BL64497
Ordnance Survey map reference S T6276SE
Scale 1:2500 reduced from 1:1250
Administrative area City of Bristol



© Crown Copyright. Reproduced by Land Registry. All rights reserved. No part of this publication may be reproduced without the prior written permission of Ordnance Survey. Licence number 100026741.

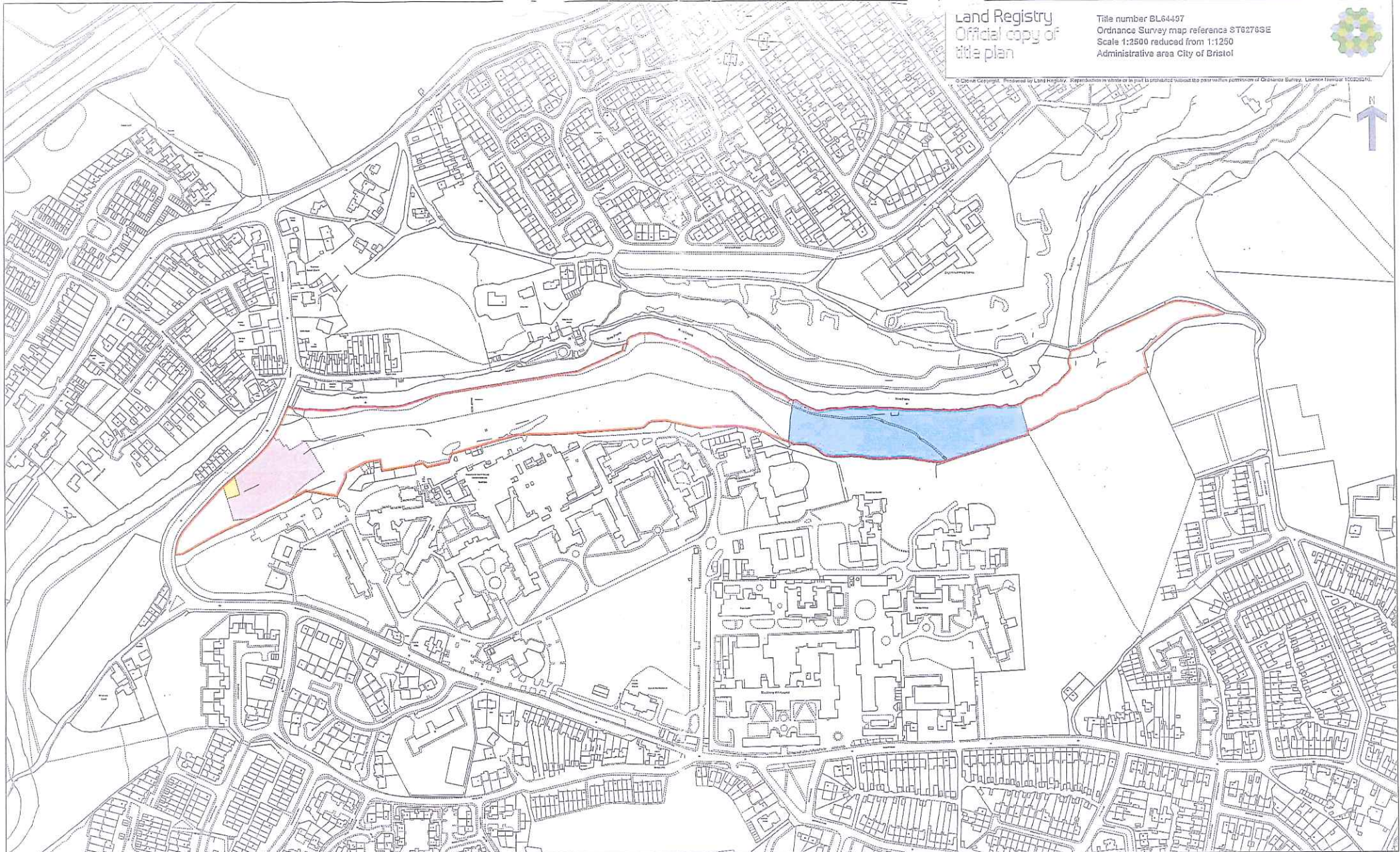

This official copy issued on 3 February 2010 shows the state of this title plan on 2 February 2010 at 16:11:51. It is admissible in evidence to the same extent as the original (s.57 Land Registration Act 2002).
This title plan shows the general position, not the exact line, of the boundaries. It may be subject to distortions in scale. Measurements scaled from this plan may not match measurements between the same points on the ground. See Land Registry Public Guide 19 - Title Plans and Boundaries.
This title is dealt with by Land Registry, Gloucester Office.

Grove Wood Appendix no: A (ii)

Land Registry
Official copy of
title plan

Title number **BL110040**
Ordnance Survey map reference **ST5879SW**
Scale **1:2500**
Administrative area **CITY OF BRISTOL**



© Crown Copyright. Produced by Land Registry. Reproduction in whole or in part is prohibited without the prior written permission of Ordnance Survey. Licence Number 100026316.

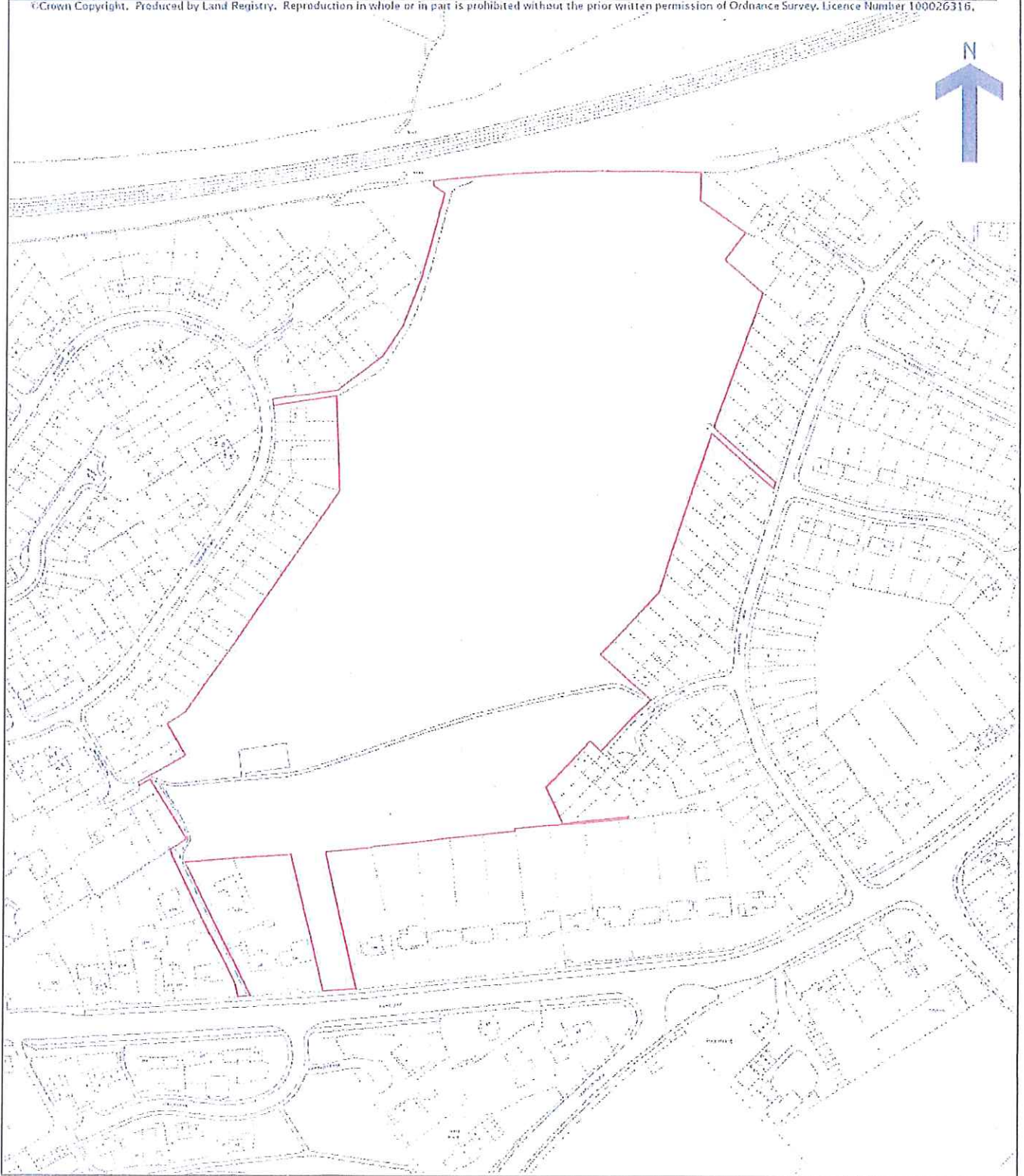

Land Registry
Current title plan

Title number BL108167
Ordnance Survey map reference ST5976NW
Scale 1:1250
Administrative area CITY OF BRISTOL



© Crown Copyright. Produced by Land Registry. Reproduction in whole or in part is prohibited without the prior written permission of Ordnance Survey. Licence Number 100026316.

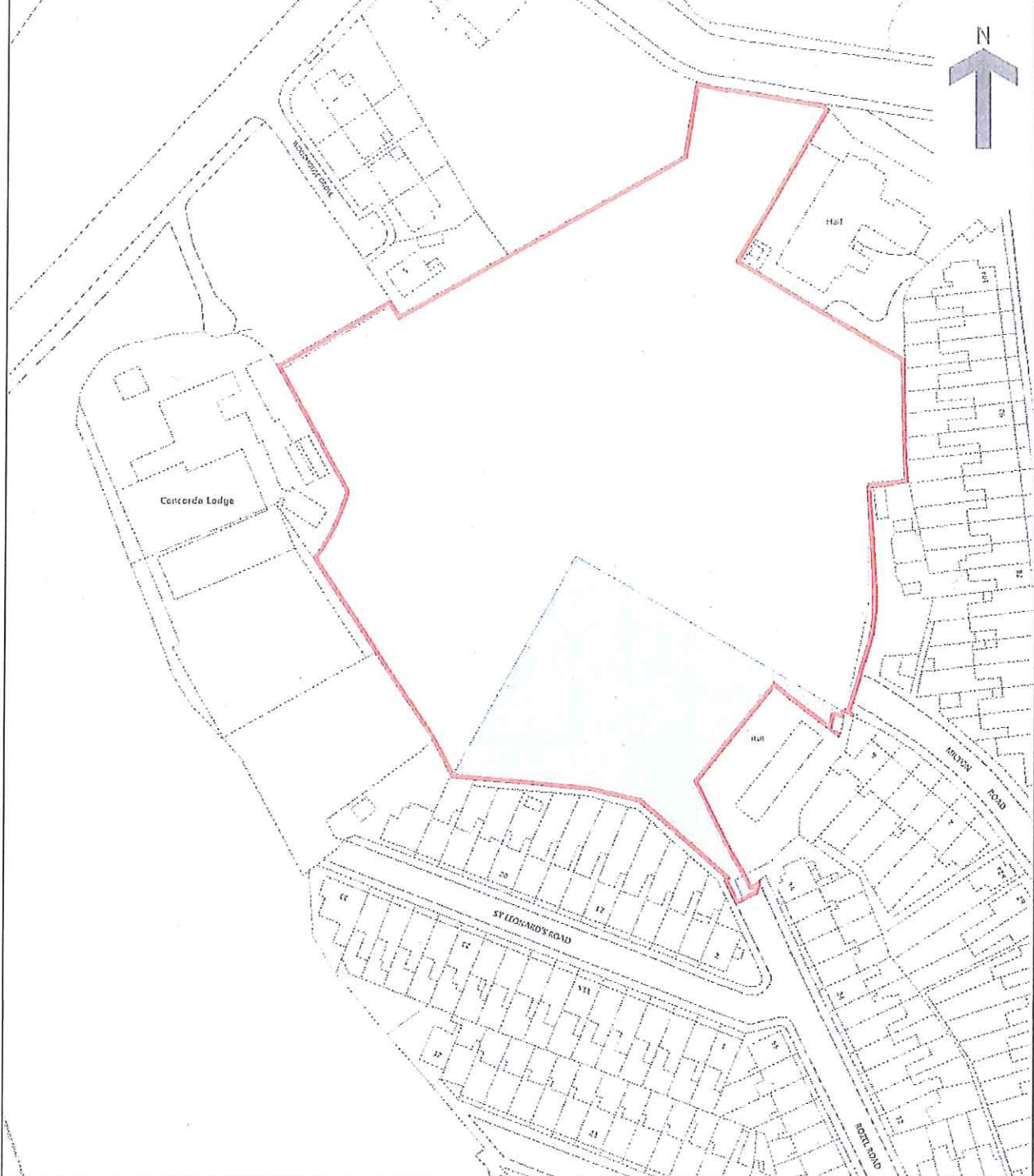

This is a print of the view of the title plan obtained from Land Registry showing the state of the title plan on 09 November 2010 at 16:43:50. This title plan shows the general position, not the exact line, of the boundaries. It may be subject to distortions in scale. Measurements scaled from this plan may not match measurements between the same points on the ground. See Land Registry Public Guide 7 - Title Plans.

This title is dealt with by Land Registry, Gloucester Office.



EXHIBIT A

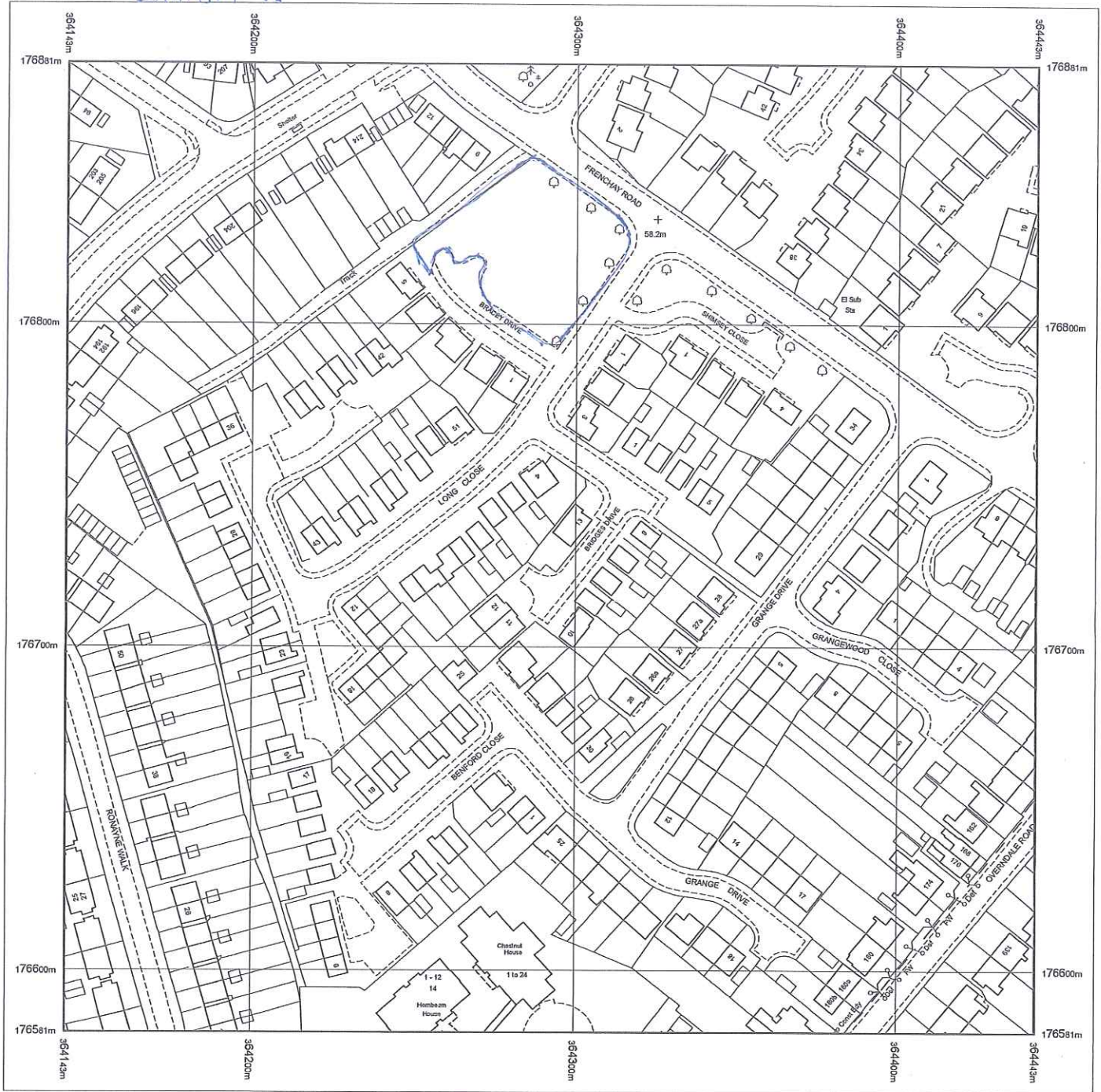

GREEN IN BLUE

Produced 17.09.2010 from the Ordnance Survey National Geographic Database and incorporating surveyed revision available at this date. © Crown Copyright 2010.

Reproduction in whole or part is prohibited without the prior permission of Ordnance Survey.

Ordnance Survey, the OS Symbol and OS Sitemap are registered trademarks of Ordnance Survey, the national mapping agency of Great Britain.

The representation of a road, track or path is no evidence of a right of way.

The representation of features as lines is no evidence of a property boundary.

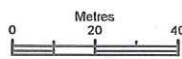

Scale 1:1250

Supplied by: Stanfords
Serial number: 00368200
Centre coordinates: 364292.75 176730.75

Further information can be found on the OS Sitemap Information leaflet or the Ordnance Survey web site:
www.ordnancesurvey.co.uk



AREA 2 HA
SCALE: 1:1250
CENTRE COORDINATES: 359813 , 171875

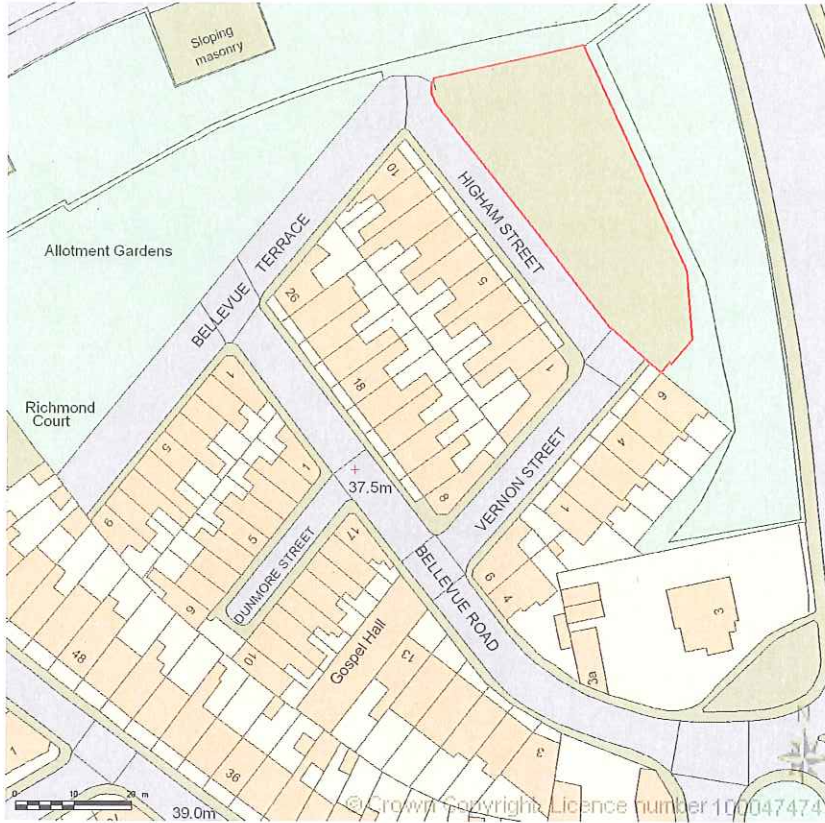

Supplied by Streetwise Maps Ltd
www.streetwise.net
Licence No: 100047474

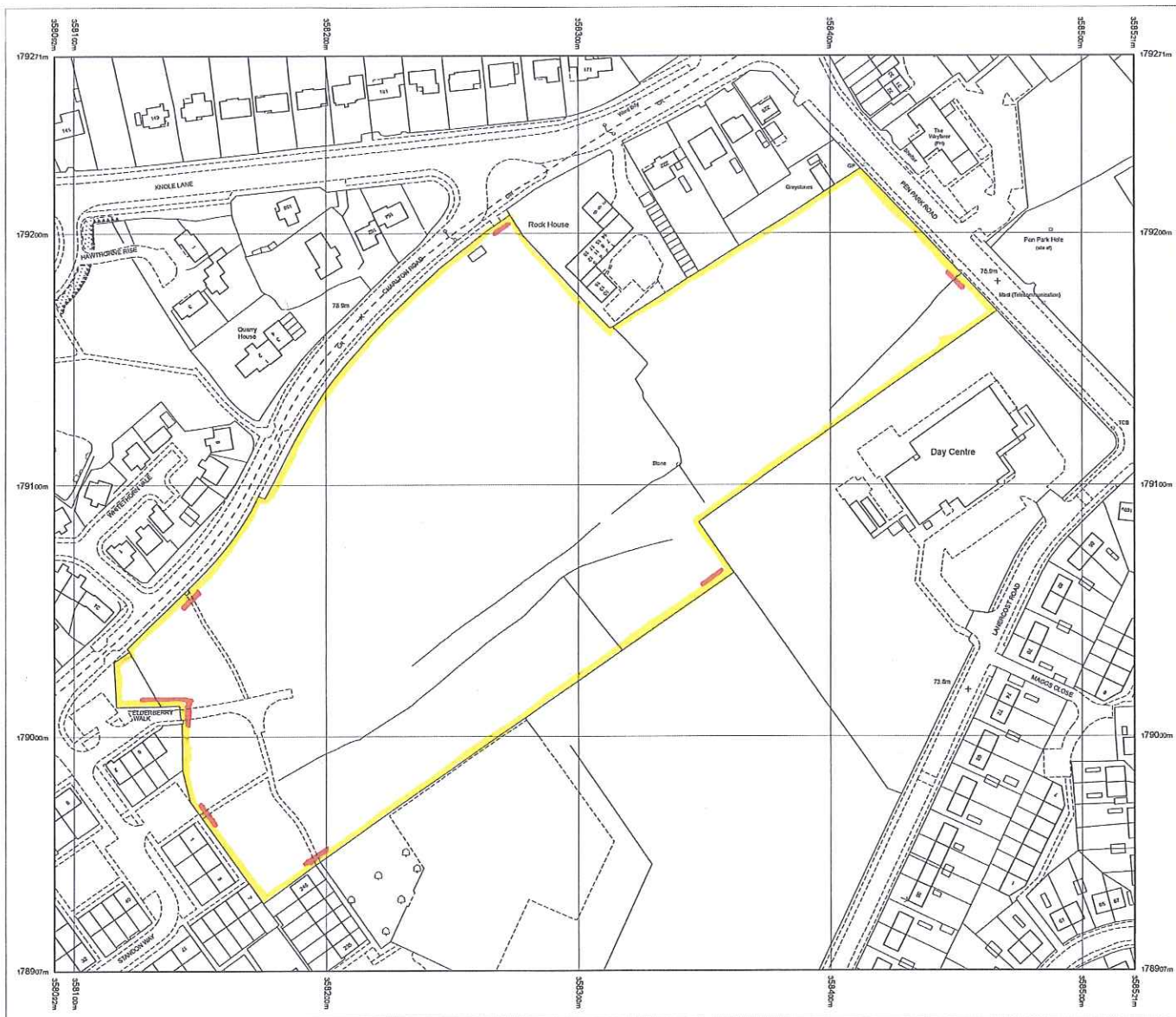

Produced 09.02.2011 from the Ordnance Survey National Geographic Database and incorporating surveyed revision available at this date. © Crown Copyright 2011.

Reproduction in whole or part is prohibited without the prior permission of Ordnance Survey.

Ordnance Survey, the OS Symbol and OS Sitemap are registered trademarks of Ordnance Survey, the national mapping agency of Great Britain.

The representation of a road, track or path is no evidence of a right of way.

The representation of features as lines is no evidence of a property boundary.

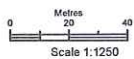

Supplied by: Stanfords
Serial number: 0039100
Centre coordinates: 558300.5 179000.75

Further information can be found on the OS Sitemap Information leaflet or the Ordnance Survey web site: www.ordnancesurvey.co.uk

Exhibit 1
MAP A.
Elderberry

an

The area edged in red on the plan represents the land to be registered as a Town Green.

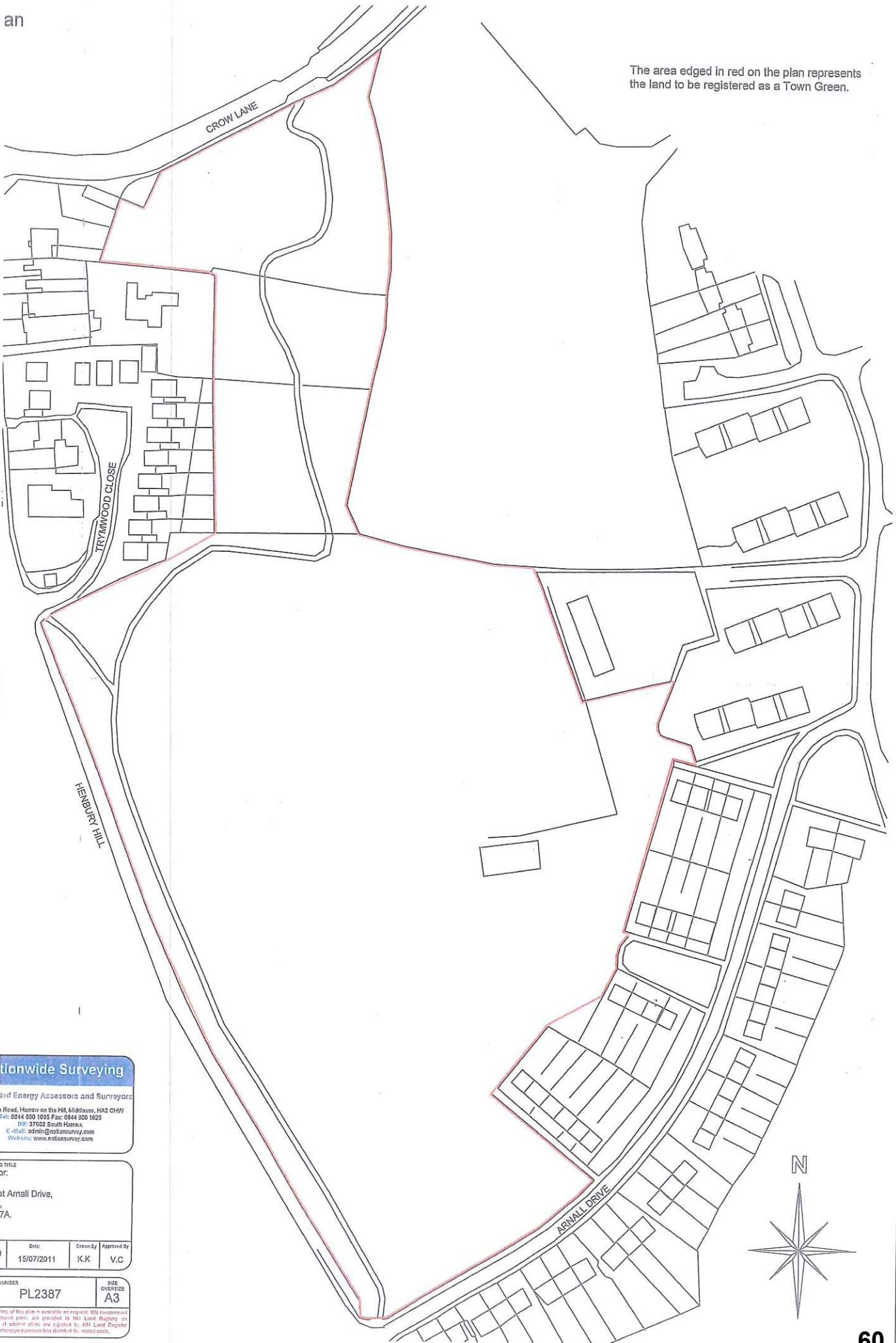

nationalwide Surveying
 Local Energy Assessors and Surveyors
 14 Road, Henbury on the Hill, Middlesax, HA2 0HW
 Tel: 0214 200 1033 Fax: 0214 203 1629
 021- 37602 South Harrow,
 E-Mail: admin@nationalwide.com
 Website: www.nationalwide.com

DATE OF:
 at Arnall Drive,
 1,
 7A.

Date:	Drawn By:	Approved By:
15/07/2011	K.K	V.C

NUMBER	SIZE
PL2387	A3

Notes: If this plan is available on request. We recommend that all plans are registered to the Land Registry as all plans above are registered to the Land Registry and all other plans are deemed to be stated as such.

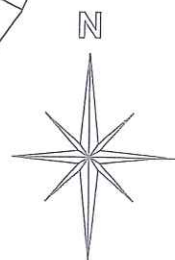

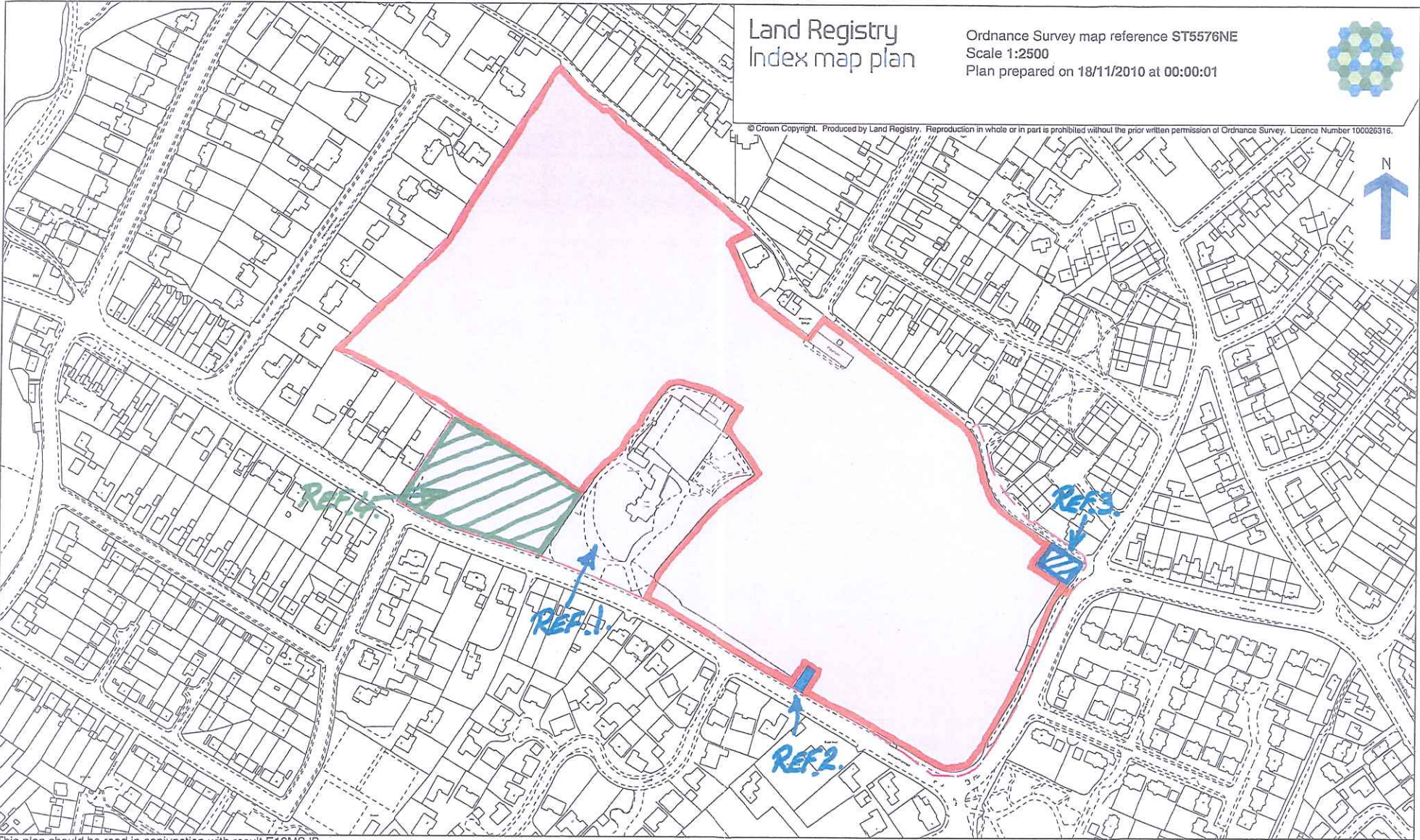

Land Registry
Index map plan

Ordnance Survey map reference ST5576NE
Scale 1:2500
Plan prepared on 18/11/2010 at 00:00:01



© Crown Copyright. Produced by Land Registry. Reproduction in whole or in part is prohibited without the prior written permission of Ordnance Survey. Licence Number 100026316.

Store lodge playing field

Appendix no: A (ix)

This plan should be read in conjunction with result E12MSJB.

This plan shows the general position, not the exact line, of the boundaries. It may be subject to distortions in scale. Measurements scaled from this plan may not match measurements between the same points on the ground. See Land Registry Public

61

SEE NOTES
OF EXPLANATION.

PLAN TWO



Scale 1:3000

Red line outlines application Boundary

